

+/-   what?

An Alternative Housing Model

ARCHITECTURE 2022

UNIVERSITY OF PÉCS
BREUER MARCEL DOCTORAL SCHOOL
FACULTY OF ENGINEERING AND INFORMATION TECHNOLOGY

STUDENT: **CHANG LU**
SUPERVISE: ÁGNES BORSOS DR.
NORBERT VASVÁRY-NÁDOR DR.

☐ ☐ + w h ☐ t ?

Co+Living design

Co+Why

Co+Who

Co+What

Co+Where

Co+How

Co+ ...

CD - what?

COMMUNITY



"Co" corresponds to 'collaborative', 'communal' and 'collective'

Co - Working

Co - Housing

Co - Design

Co - Living

Co - Create

Co - Life

Co - Connect

Co - Existence

Co - Operative

Co - Active

Co - Space

.....

From Living to Sharing...

From living to Co-living...

-

Live out of your imagination
and build a home together

EO – Living

An alternative housing model

1

BACKGROUND RESEARCH

Co+Why

Why is co-living

Co-Living Housing Demand

Co+Who

Who will live in co-living

Co-living New Family Structure

Co+What

What is co-living

Co-Living is Everywhere

[1, 2, 3]

2

CASE STUDY

Co+Where

Co-Living is Everywhere

[4]

3

MY DESIGN PROPOSAL

Co+How

Co-Living Design

[5]

4

CONCLUSION

Co+Living
Design

Co+Living Design

[6]

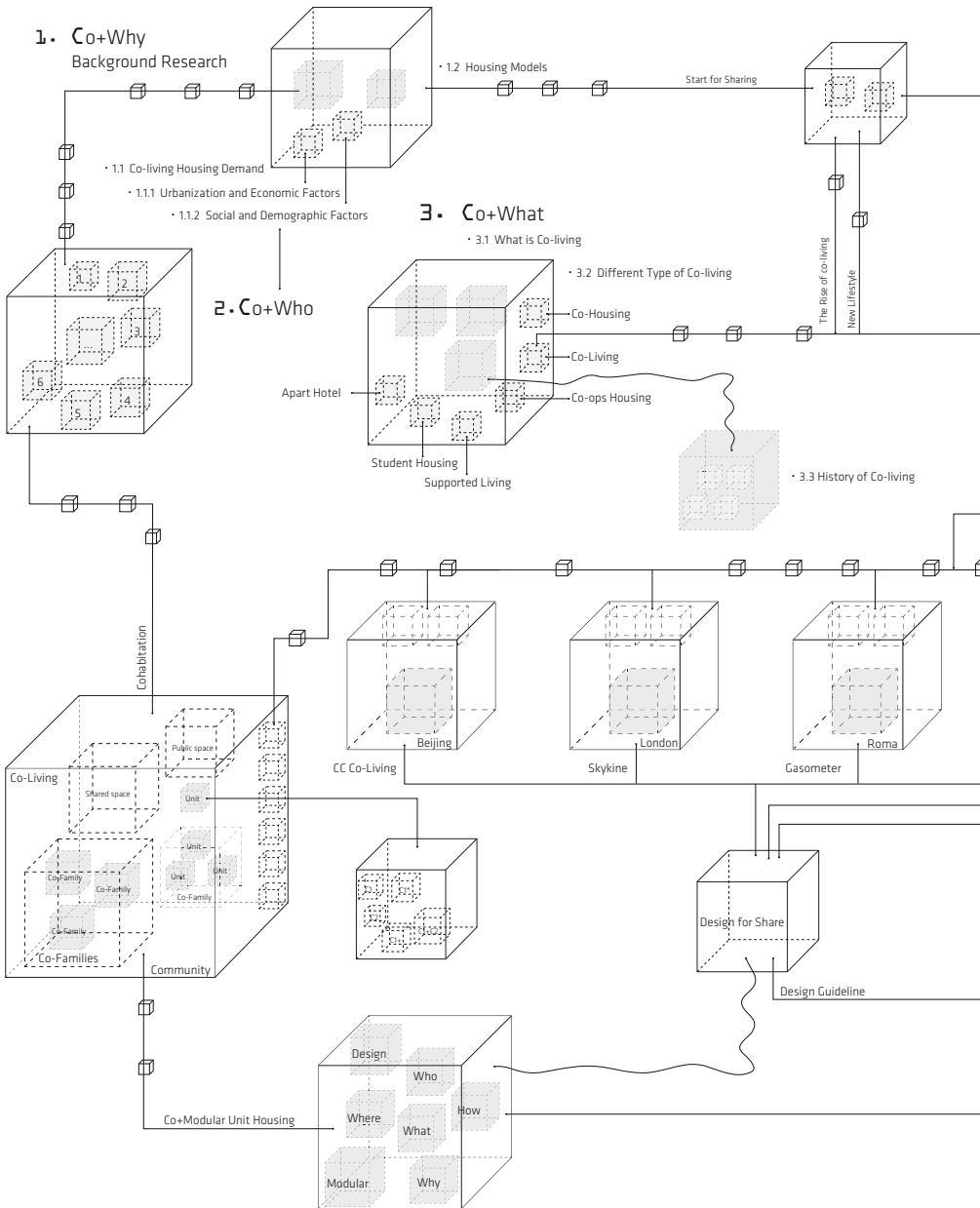

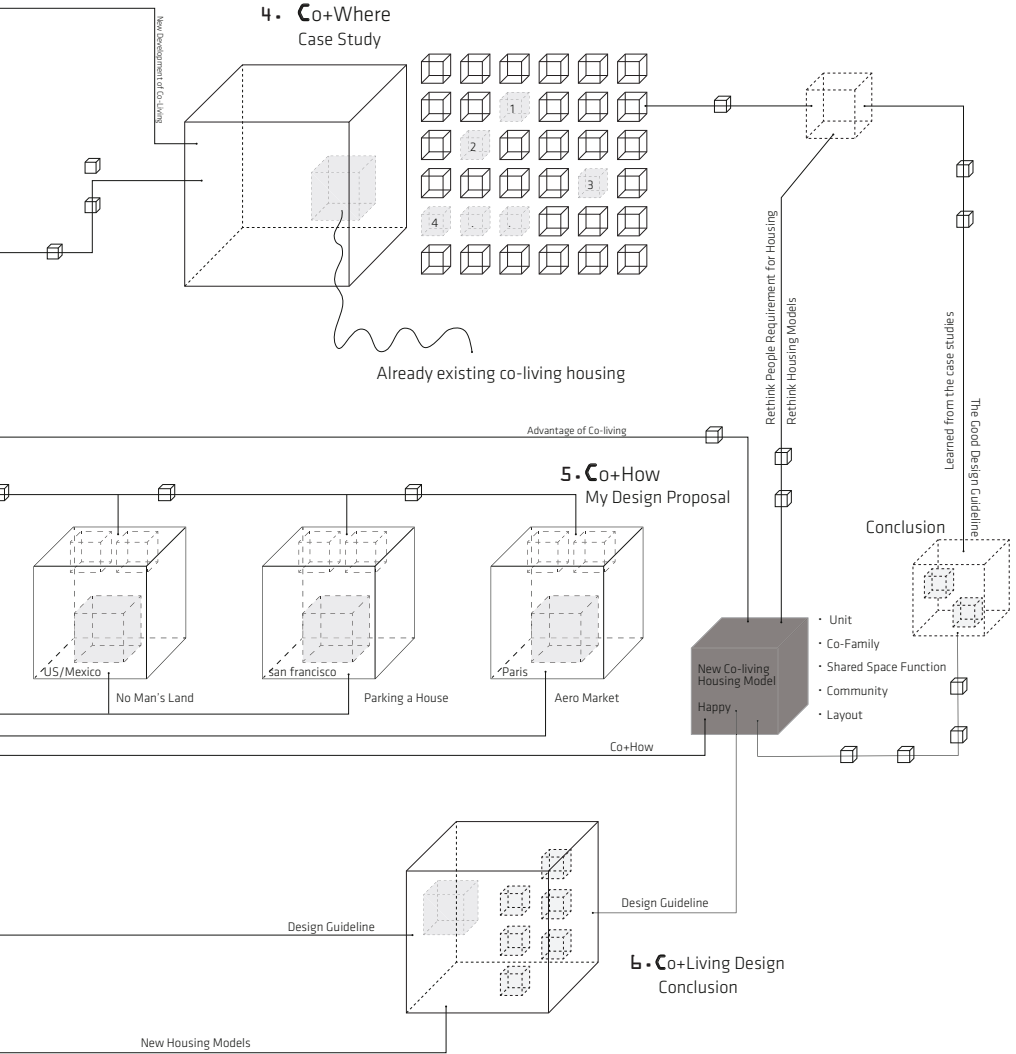

THESIS 0  Co+Living Design

THESIS 1  Co+Why

THESIS 2  Co+Who

THESIS 3  Co+What

THESIS 4  Co+Where

THESIS 5  Co+How

THESIS 0 :  Co+Living Design

Co+living design was created to explore an alternative housing model, utilizing it to conceptualize and design a co-living housing model for life-enhancing living environments for different types of people and more inclusive co-living buildings.

THESIS 1 :  Co+Why

As the background research confirmed, the economic and social effects of demographic change create new housing demand. The rise of co-living illustrated that traditional family structure apartments do not suit the needs of inhabitants. As a result, it's important evaluating what a contemporary home should offer in terms of new requirements and who it's designed for and new housing model with spatial layouts should be reconsidered.

THESIS 2 :  Co+Who

The demographic change has resulted in a new family structure, with the co-living housing model following the new groups, in which individuals live together not just because they are related by blood, but also because they are trying to solve a housing problem.

THESIS 3 :  Co+What

The Co+Living Design proposes an alternative new housing model and enables people to live together in an urban setting with spatial activity and individual characteristics. It is an effective solution for a growing demographic that's worth considering.

THESIS 4:  Co+Where

The propose research site chosen is the main city of different countries, these cities all face different housing problems. The goal is to allow people to adapt their needs and preferences to the built environment of the future.

THESIS 5:  Co+How

The modular design could be a solution to create a co-living community because of its flexibility to changes caused by employment, education, or other factors. This study according the background research, case study and practice design to propose a design guideline for to create co-living community, that appropriate for each project in the practice. At the same time, the propose six design guidelines will be applicable to every building for designing a new a co-living housing to make co-living as a new alternative housing model in the urban.

CO+LIVING DESIGN GUIDELINE

CO+  CO-LIVING DESIGN

CO+  HOUSING MODEL

CO+  MODULAR UNIT

CO+  PRIVATE UNIT

CO+  SHARED SPACE

CO+  NEW BORDER

CO+ CO-LIVING DESIGN

Co+living design was created to explore an alternative housing model, utilized to conceptualize and design a co-living housing model for life-enhancing living environments for different types of people and more inclusive co-living buildings. The private living space as a unit in a co-living community, different type of unit connects with shared space. Another idea is co-unit extend to co- family connects with multifunction shared space in common area, also has the shared space in each co-family unit. It will be proposing two cores of co- living community. There propose 6 type of unit layout which is good for design co-living community.

The center layout may effectively connect the shared area in the center with the surrounding living units, creating a huge open space in the center while maintaining the privacy for living unit. The center layout is suitable for the interior of the building as well as the overall planning of the building. In a co- living community, a linear layout can be better used to modular shared insert private living units. To combine linear layout and center layout can also be well applied to co-living.

LAYOUT

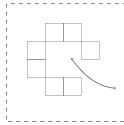

Center

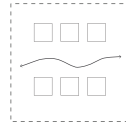

Liner

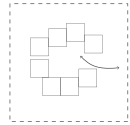

Cluster

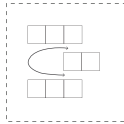

Parallel

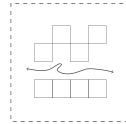

Compact

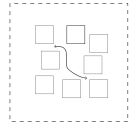

Loose

CO+ HOUSING MODEL

There are two types of Co-living housing model: Co-Unit with shared space and Co-family with shared space. The number of rooms determines the type of co-unit; the maximum number of rooms is four. Co-family can be made up of different people, such as friends, colleagues, even strangers without blood, as well as multi-generational living together. There is also the option of a traditional family structure or a combination of both, with a maximum of 10 rooms.

HOUSING MODEL

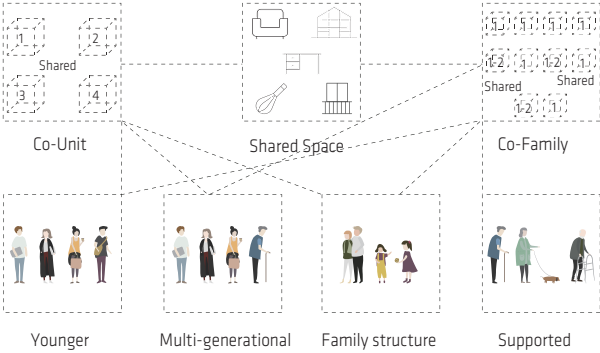

CO+  MODULAR UNIT

Modular design is a good solution for designing a co-living community. Different types of modular units and shared space areas vary according to the needs of different houses to meet the needs of different residents. The modular design is fast and efficient, while maximizing the privacy of private spaces and the interaction of shared spaces. Modular design also can use for furniture design for Co-living unit.

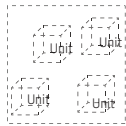

Co-Unit

+

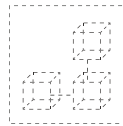

Shared Space



Co-Family

MODULAR UNIT

CO+  PRIVATE UNIT

The potential to reinvent private space by spatial layout and multifunctional furniture. Modular and multifunctional can provide flexibility in use, making it simple for residents to adapt the space to their specific needs

PRIVATE MODULAR UNIT



C1 Unit



C1+Unit



C1++Unit



C1*Unit

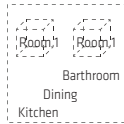

C2



C3



C4

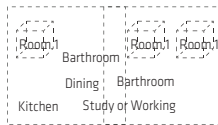

C1+C2

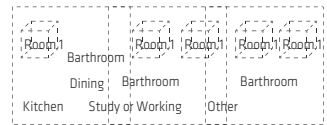

C1+C2+C2

CO+  SHARE SPACE

Shared space is core of co-living, by creating different levels of shared space and providing different types of interaction, which it can be layout the center of the building or liner layout, make it can easy to research for everyone. While in a co-family unit with the shared space can be the working or study area, living area or kitchen and dining this basic social area.

The size of the shared space will according the type of the co-living housing, such as for young with the small size of the living unit need more shaped space. If the community for multi-generation and with the different type of living unit, the shared space should conders different user requirement, such as old people or younger even child. While it can including the common area for multi-generation community.

SHARED SPACE

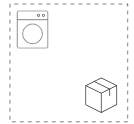
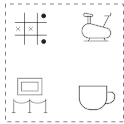

CO+  NEW BORDER

The typical family house or single apartment has a clear boundary from the outside. As well as the room with room and other functions. But the residents are strangers with different personalities, occupations, and living habits in co-living. This kind of non-blood cohabitation has certain social attributes in itself. Focus on the relationship between housing and urban space, as well as the private and shared space. Typical dwellings include private units and common spaces which are corridors and stairs are. The new shared housing model is a kind of living space activity in which self-weight adjusts the balance of internal supply and demand due to the sharing of living environment with the shrinking of family size, changes in population structure, and the increase of remaining living space resources.

The kitchen and living room can be in a private space or in a shared function. While public spaces as one part of shared spaces, and private spaces such as study and work can also be part of shared functions.

The role of defining new space boundaries in the building is based on the needs of the people.

NER BORDER

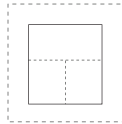

Flexible Space

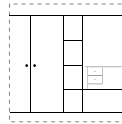

Multifunctional Furniture

SINGLE [1]



Student



Adult



Elderly

COUPLE/DOUBLE [2]



Couple



One of LAT couple



Elderly Couple

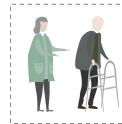

Couple with a Disabled



Single Parent

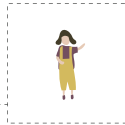

Child

Blood



Single Parent



Child

Blood



Grandma/Grandpa

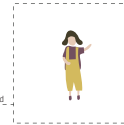

Child

Blood



+



Friends



+



Colleagues



+



Strangers



Disabled

+



Nurse



Elderly

+



Nurse



Household

+



Travels/business

SINGLE++ [3]



Student

Adult

Adult

Student

Adult

Elderly

Strangers/Friends/Colleagues

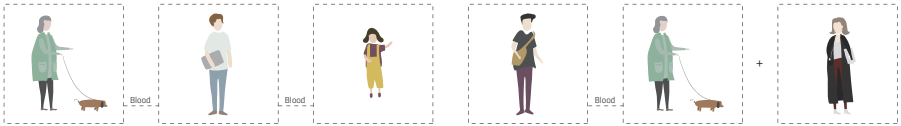

Elderly

Single Parent

Child

Child

Single Parent

Adult

COUPLE+ [3]



Parents

Child

Couple

Adult

Elderly Couple

Student/Adult



Couple

One of Parent

Couple

Elderly

Couple

Adult

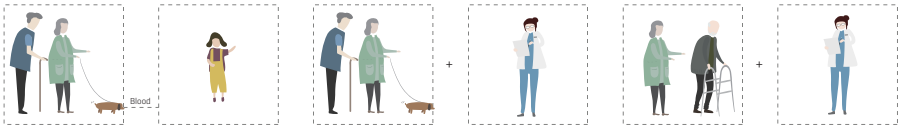

Grandparents

Child

Elderly Couple

Nurse

Couple with a Disabled

Nurse

SINGLE+++ [4]

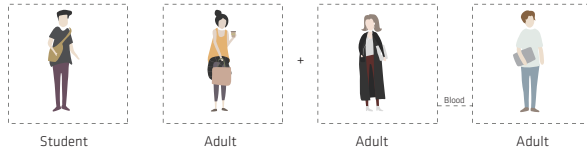
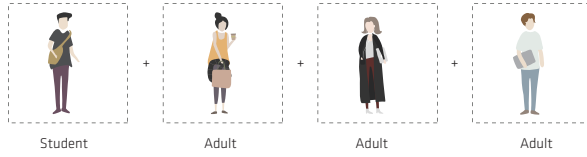

COUPLE++ [4]

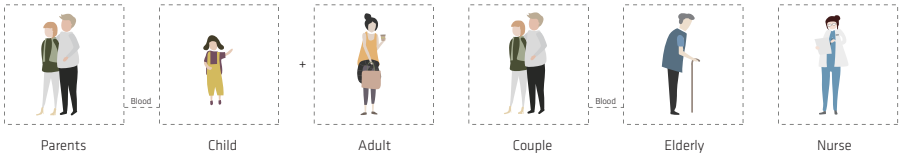
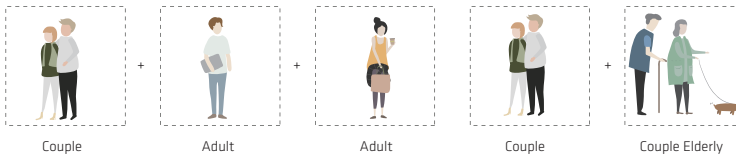
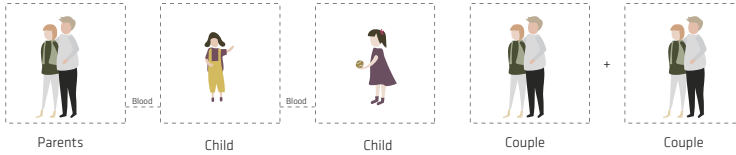



SINGLE++++/COUPLE+++ [5]

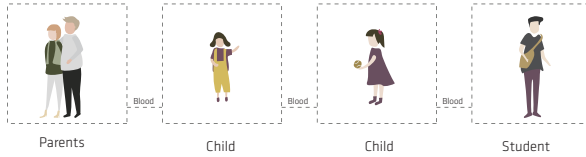
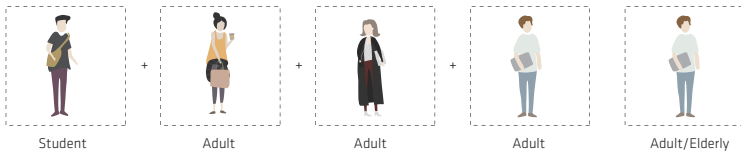

SINGLE+++++/COUPLE++++ [6]

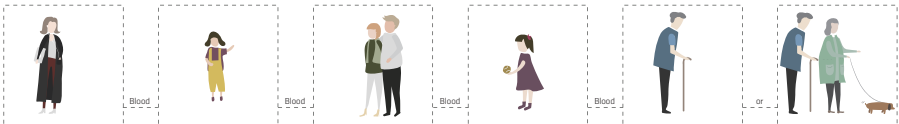

MORE...

